

Replacement Parts Diagram

Model 950 Series A-E

PROPRIETARY RIGHTS NOTICE This document and all information contained within it is the property of Hamilton Beach Brands, Inc. (HBB). It is confidential and proprietary and has been provided to you for a limited purpose. It must be returned or destroyed upon request. Disclosure, reproduction or use of this document and any information contained within it, in full or in part, for any purpose is forbidden without the prior written consent of HBB. No photographs may be taken of any article fabricated or assembled from this document without the prior written consent of HBB.

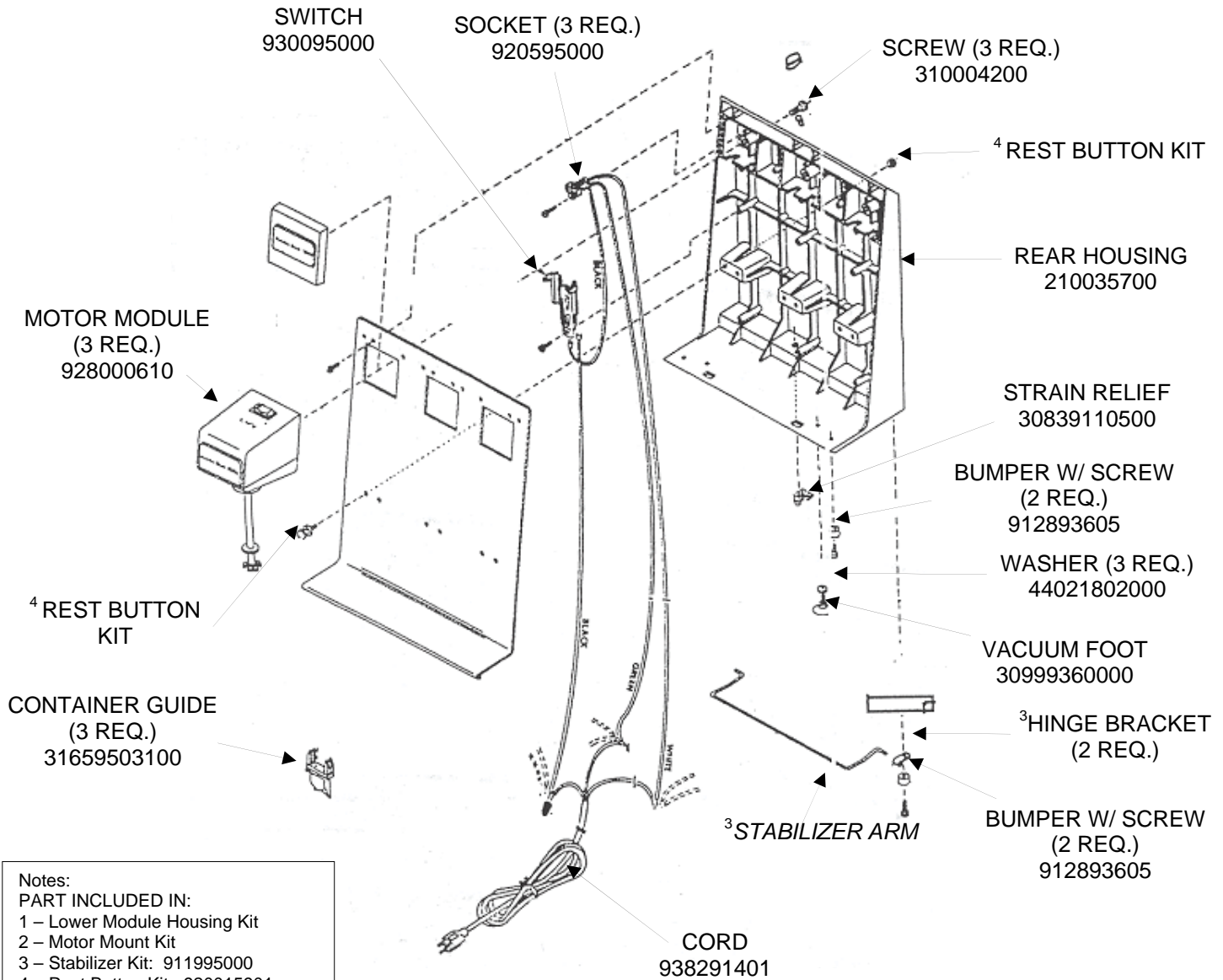

Notes:

- PART INCLUDED IN:**
- 1 – Lower Module Housing Kit
 - 2 – Motor Mount Kit
 - 3 – Stabilizer Kit: 911995000
 - 4 – Rest Button Kit: 920015901
 - 5 – Lower Bearing Kit

 4421 Waterfront Drive Glen Allen, VA 23060	Revision Description:		Replaced 31409300000 with 990043600			
	Request Number:	CME-2758	Revision Date:	7/19/10	Approved by:	CME-2758
	Issue Code(s):	CS, SP	Page:	1 of 3	Document #:	510001700
					Rev:	C

Replacement Parts Diagram Model 950 Series A-E

PROPRIETARY RIGHTS NOTICE This document and all information contained within it is the property of Hamilton Beach Brands, Inc. (HBB). It is confidential and proprietary and has been provided to you for a limited purpose. It must be returned or destroyed upon request. Disclosure, reproduction or use of this document and any information contained within it, in full or in part, for any purpose is forbidden without the prior written consent of HBB. No photographs may be taken of any article fabricated or assembled from this document without the prior written consent of HBB.

950 MOTOR MODULE ASSEMBLY

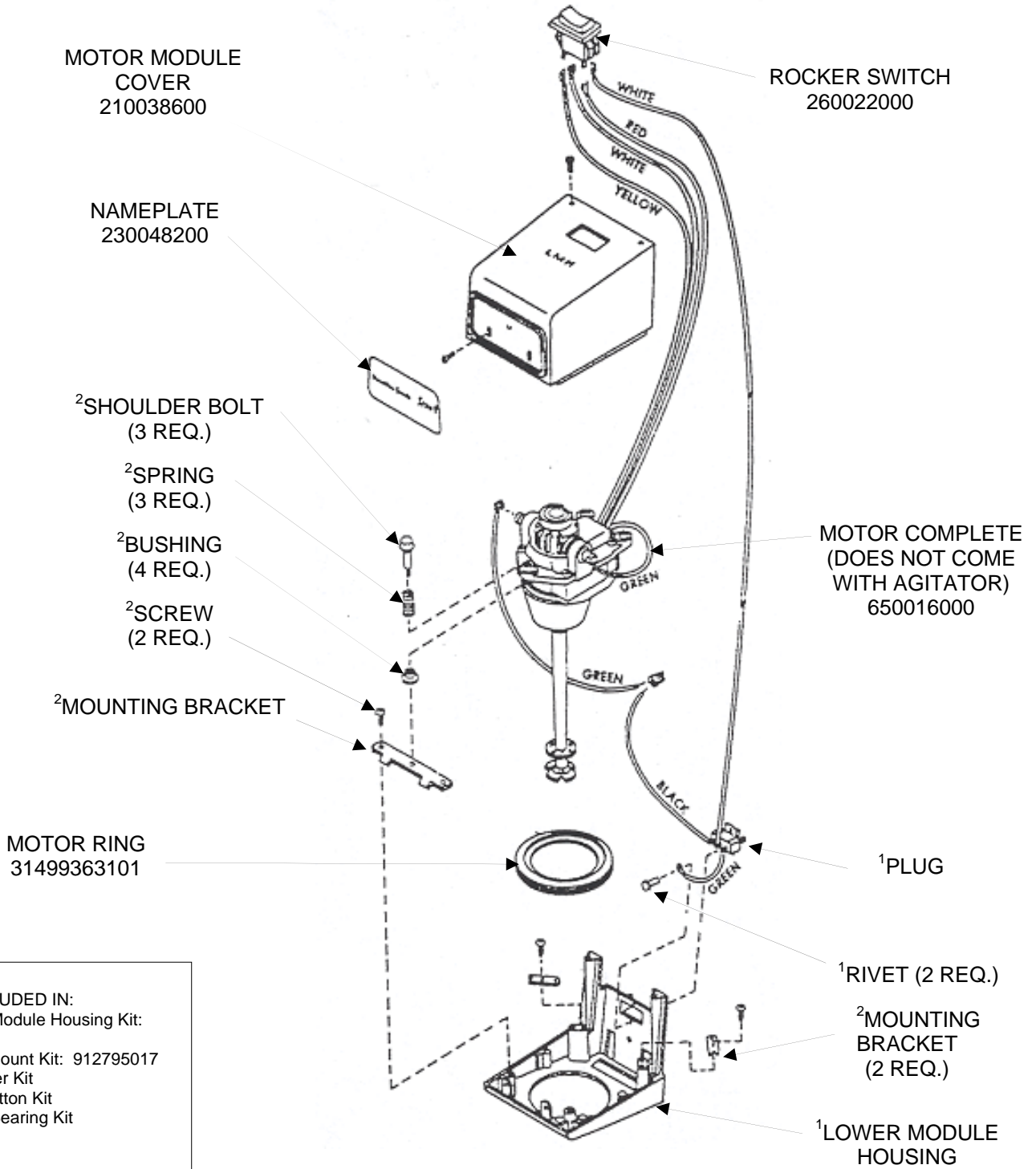

Notes:
PART INCLUDED IN:
1 – Lower Module Housing Kit:
910037500
2 – Motor Mount Kit: 912795017
3 – Stabilizer Kit
4 – Rest Button Kit
5 – Lower Bearing Kit

 4421 Waterfront Drive Glen Allen, VA 23060	Revision Description:	Replaced 31409300000 with 990043600					
	Request Number:	CME-2758	Revision Date:	7/19/10	Approved by:	CME-2758	
	Issue Code(s):	CS, SP	Page:	2 of 3	Document #:	510001700	Rev:

Replacement Parts Diagram

Model 950 Series A-E

PROPRIETARY RIGHTS NOTICE This document and all information contained within it is the property of Hamilton Beach Brands, Inc. (HBB). It is confidential and proprietary and has been provided to you for a limited purpose. It must be returned or destroyed upon request. Disclosure, reproduction or use of this document and any information contained within it, in full or in part, for any purpose is forbidden without the prior written consent of HBB. No photographs may be taken of any article fabricated or assembled from this document without the prior written consent of HBB.

950 MOTOR ASSEMBLY

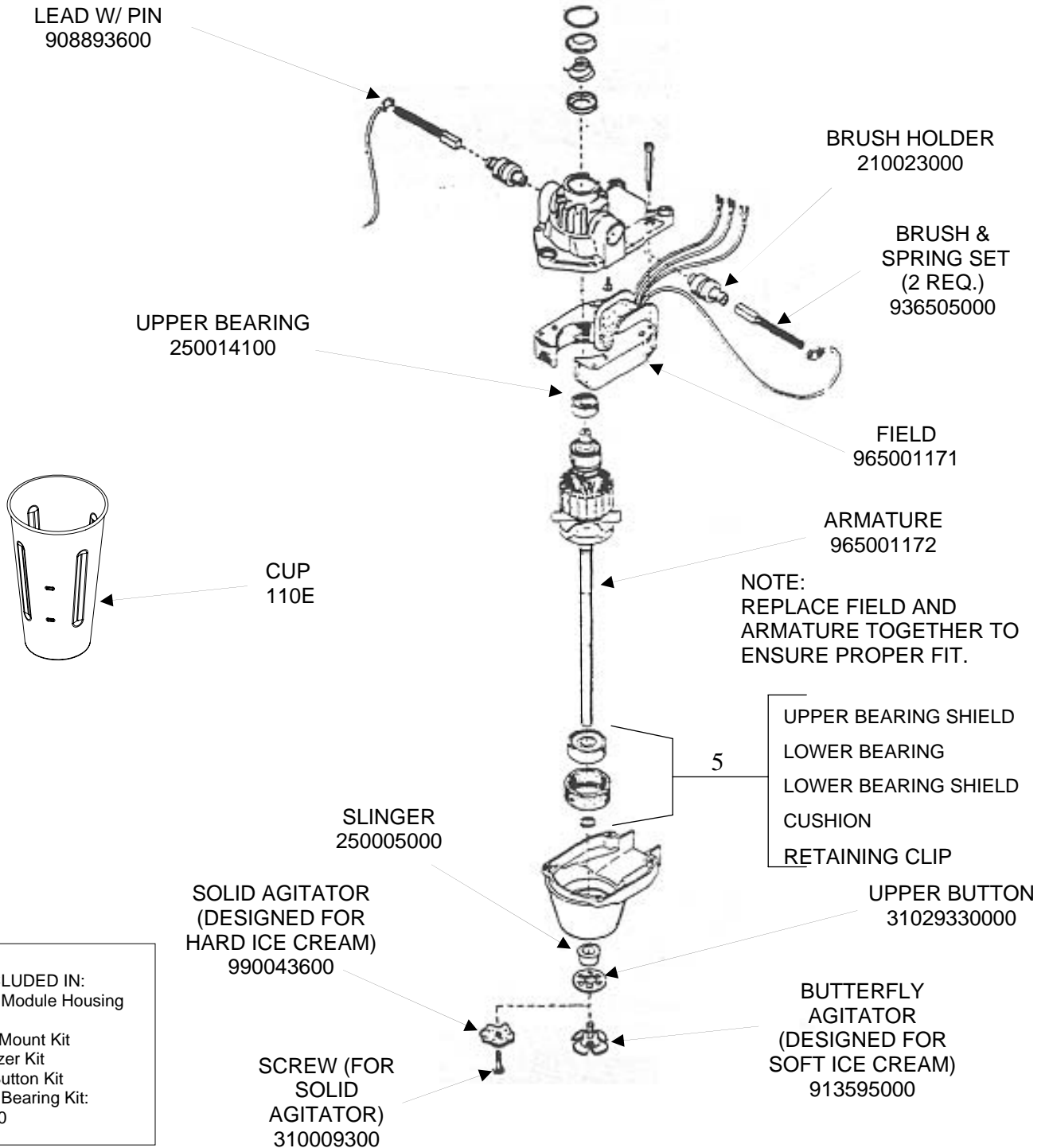

Notes:
PART INCLUDED IN:
 1 – Lower Module Housing Kit
 2 – Motor Mount Kit
 3 – Stabilizer Kit
 4 – Rest Button Kit
 5 – Lower Bearing Kit: 950012400

4421 Waterfront Drive Glen Allen, VA 23060	Revision Description:	Replaced 31409300000 with 990043600					
	Request Number:	CME-2758	Revision Date:	7/19/10	Approved by:	CME-2758	
	Issue Code(s):	CS, SP	Page:	3 of 3	Document #:	510001700	Rev: